



OFFICIAL PARTNER



Rental Rates for The Epic Theater

| 8 Hour Pricing | | |
|---|--------------------------------|------------------------------|
| | Weekdays Mon-Thurs (8 Hours) | Weekends Fri-Sun (8 Hours) |
| Space | \$1,500* | \$2,500* |
| Audio (optional) | \$300** | \$300** |
| Lighting (optional) | \$300** | \$300** |
| Total | \$2,100 | \$3,100 |
| 4 Hour Pricing | | |
| | Weekdays Mon-Thurs (4 Hours) | Weekends Fri-Sun (4 Hours) |
| Space | \$750* | \$1,250* |
| Audio (optional) | \$150** | \$150** |
| Lighting (optional) | \$150** | \$150** |
| Total | \$1,050 | \$1,550 |
| Additional 2 Hours to be added | | |
| | Weekdays Mon-Thurs (2 Hours) | Weekends Fri-Sun (2 Hours) |
| Space | \$375* | \$625* |
| Audio (optional) | \$75** | \$75** |
| Lighting (optional) | \$75** | \$75** |
| Total | \$525 | \$775 |
| 4 hour rental minimum - This includes set up time and time for all items and attendees to leave space | | |
| *Subject to change based on times of rental. Any rental that runs later than operating hours will have a \$150 fee per hour added to the rate. No events (including cleanup) will be approved to go later than midnight. | | |
| **Subject to change based on holidays & available contractors | | |
| Additional Charges | | |
| Additional charges must be added to agreement at least 30 days in advance. No guarantee on availability and no additions/changes will be made day of event. | | |
| | Weekdays Mon-Thurs | Weekends Fri-Sun |
| Sugar Percussion Drum Kit | \$50 | \$100 |
| Yamaha Digital Piano | \$25 | \$50 |
| Balcony | \$50 | \$100 |
| Theater Foyer | \$150* | 200* |
| Concessions | \$10/Hr (4 Hour Minimum) | \$10/Hr (4 Hour Minimum) |
| 2nd Cash Bar | \$250 (Balcony Only) | \$250 (Balcony Only) |
| Tables/Chairs | Free with Rental | Free with Rental |
| Projector Screen (on stage) | Free with Rental | Free with Rental |
| Projector | Free with Rental | Free with Rental |
| Online Ticketing Service | Free with Rental | Free with Rental |

If you are looking to rent the theater, please fill out our online form found at JoinTheEpic.com. Rentals must be fully booked 30 days in advance. Any walkthroughs of the venue must be made by appointment. Please contact Krista Marrs at kmarrs@gptx.org for additional information.

Building Hours: Mon.-Thurs. 5:30 am-10:00 pm | Fri. 5:30 am-9:00 pm | Sat. 8:00 am-8:00 pm | Sun. 11:00 am-6:00 pm

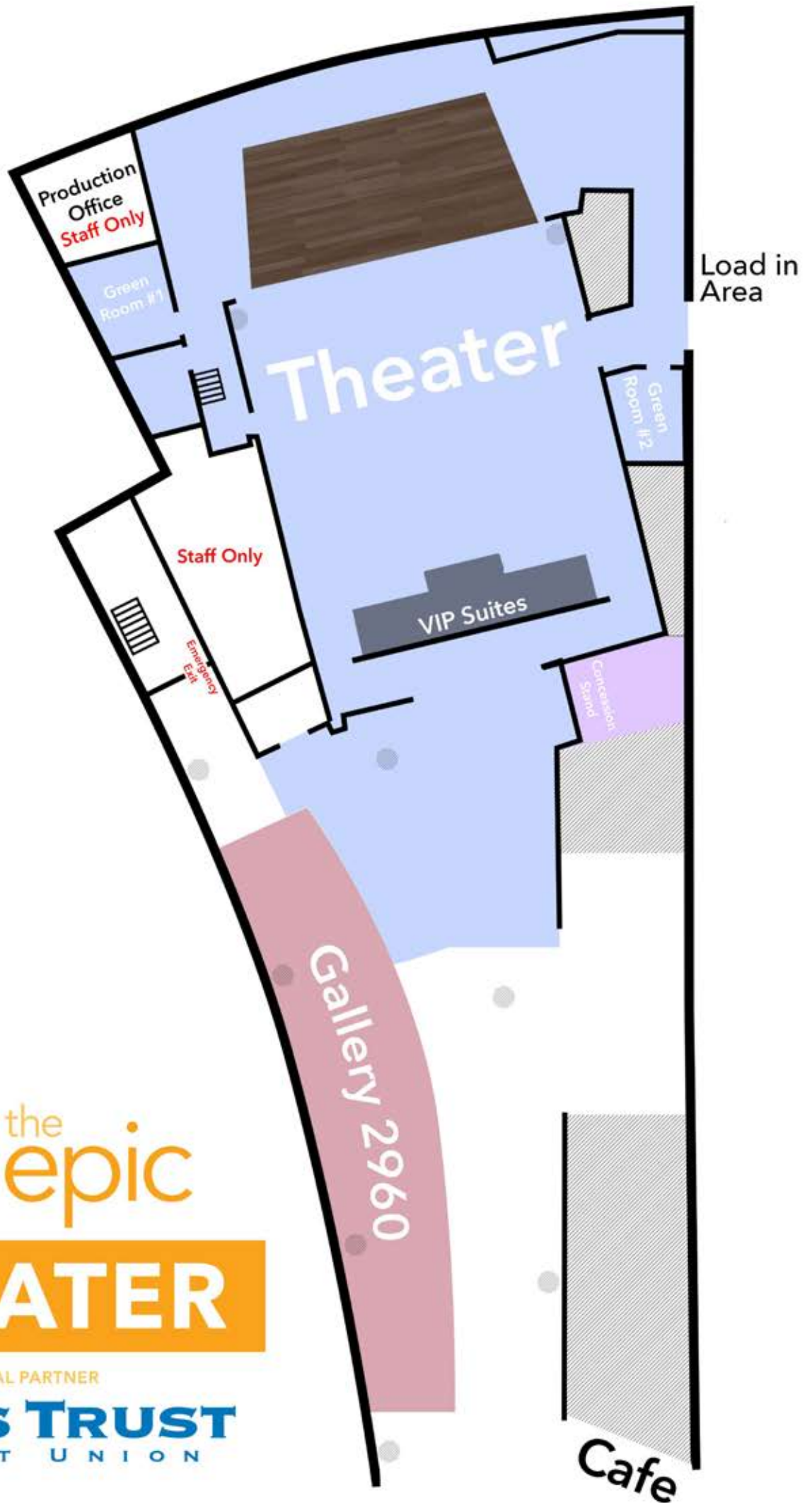

THEATER

OFFICIAL PARTNER

TEXAS TRUST
CREDIT UNION



THEATER

OFFICIAL PARTNER
TEXAS TRUST
CREDIT UNION

1st Floor Theater

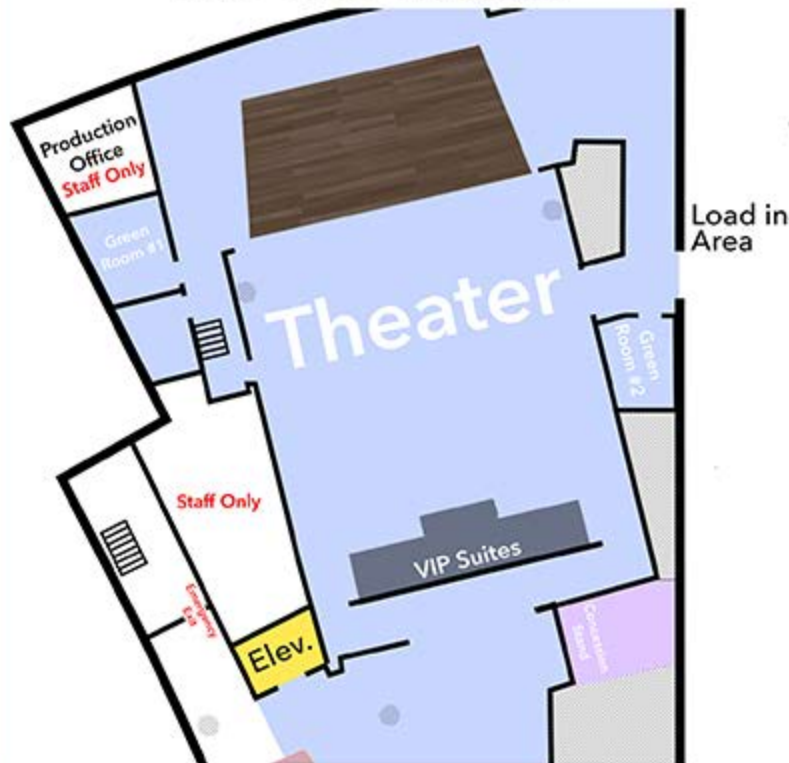

2nd Floor Balcony

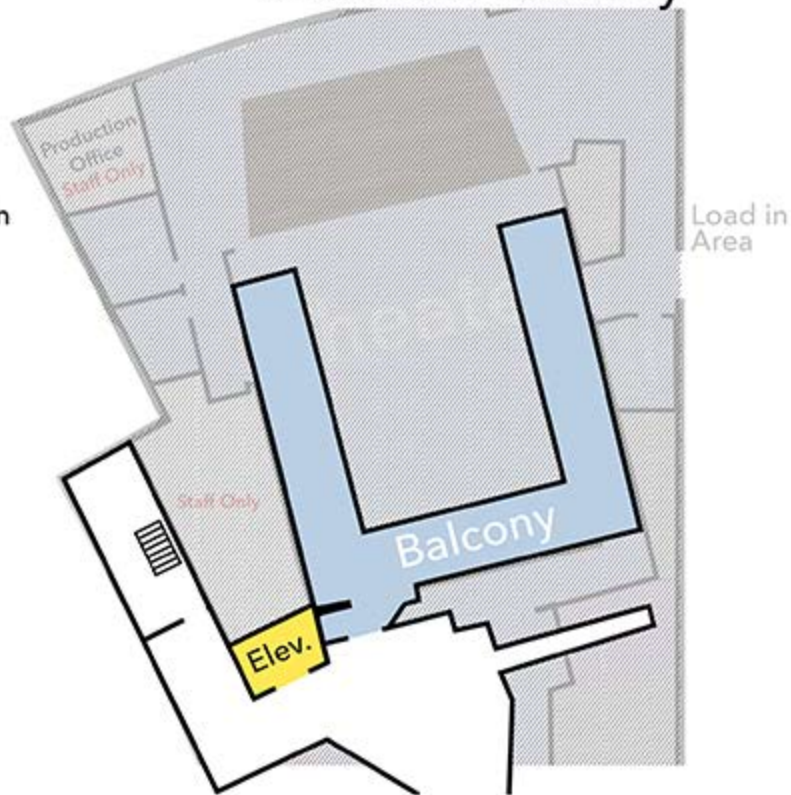

Balcony can seat approx. 45 persons**